



SDM

**Smart Design for
Manufacturing**

Be Smart. Think Smart.

¿ Who is **SDM** ?

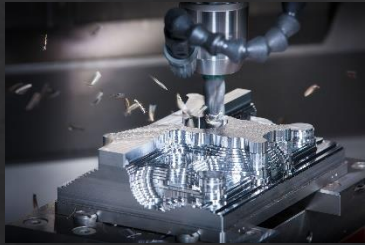

Smart Design for Manufacturing is a **company** established in Monterrey, N.L. Mexico dedicated to provide services to **industry and engineering development** in manufacture of specialized machining, offering durability, increased functionality and high standards by covering the end-to-end process from design to production of the pieces, always seeking to offer the **best solution at the shortest time and the best cost-effective investment.**



**DESIGN • ENGINEERING •
PROGRAMMING • MANUFACTURING
• CNC MACHINING •
CONTINUOUS IMPROVEMENT**



**QUALITY • INNOVATION •
PERSONALIZATION • COMMITMENT
• LOYALTY • CONGRUENCE**



**100% MEXICAN COMPANY
END TO END PROCESS COVERED**

Immediate response

Technical specialists

Personalized attention

Understanding your urgencies

Confidentiality & Trust

SOLUTIONS • TRANSPARENCY • QUALITY • DURABILITY • NATIONAL

Smart Company

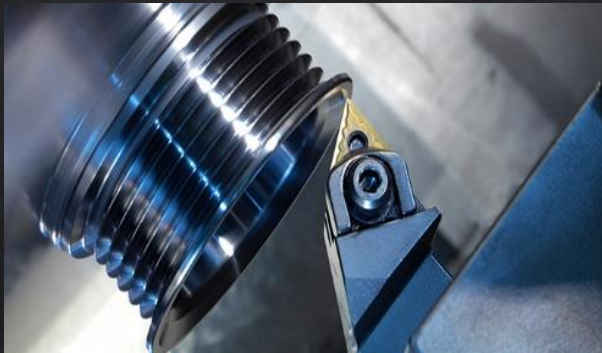

At **SDM** we specialize in:

- 🔄 3D Design, development and manufacturing of industrial parts
- 🔄 Projects focused on continuous improvement
- 🔄 Reverse engineering
- 🔄 Fixtures & prototypes
- 🔄 Die Cast – Molds, Plastic and Injection Mold
- 🔄 Machined dies and devices
- 🔄 All types of parts by CNC with high precision requirement and fine tolerances

Smart Design

Machining

Reverse engineering

Design

Programming

Manufacturing

Assemble

Other Services

Improvement projects

User training

Technical assistance

Ahab. Aesthetic

Prototypes



**Commitment to
Excellence**

Guaranteed quality
from start to finish



**Competitive and
Professional experience**



**Technical Competence
and Qualified Specialists**



**Technological innovation
and development**

**New generation CNC
machines**



**Manufacturing
Domain**



**High precision and
Fine tolerances**



**End to End
Process**





**Traceability and
Transparency**



Machining - Molds - Dies

Smart Line of business

 Injection

Forming 

CLASE

 Compression

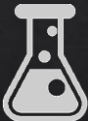

Chemical /
Pharmaceutical 

GIRO

 Automotive

Food   Oil



Smart Services

Industrial Services

- 🔄 Precision machining
- 🔄 Technical services
- 🔄 Spare parts

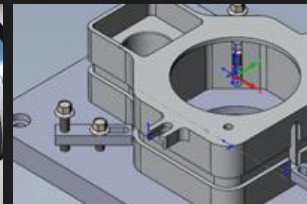
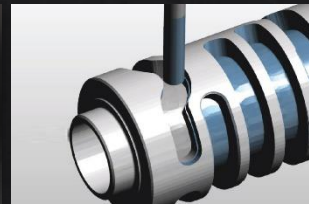

Mechanical Design

- 🔄 CAD, CAM, CAE, CNC
- 🔄 Simulations
- 🔄 Tooling and integration of assembly lines



Other **Smart** Services

- 🔄 Flat Grinding
- 🔄 Welding and Pailer Center
- 🔄 Cutting and Roughing Area



Smart Resources

CNC Machining Centers and CNC Lathes Models 2015-2019

CNC Lathes

- ↻ Distance between centers (1000mm) - 40.0"
- ↻ Tipping diameter (400mm) - 16.0"

Milling Machine: 4 axes

- ↻ X axis Max. (1000mm) - 40.0"
- ↻ Y axis Max. (500mm) - 20.0"
- ↻ Z axis Max. (600mm) - 22.5"
- ↻ 4th axis

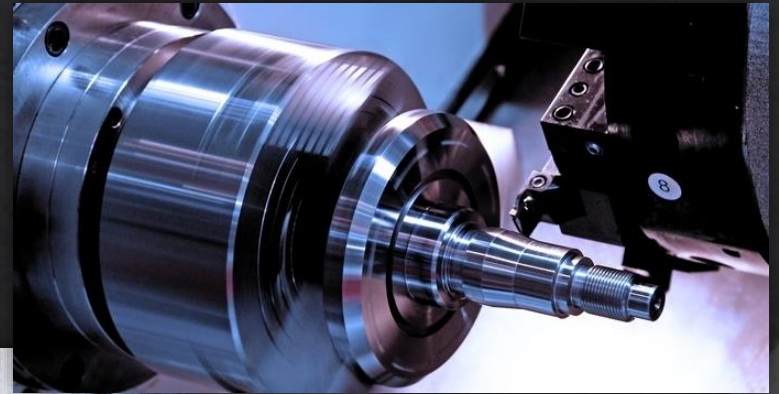

Smart Resources

- 🔄 **EDM Machine** 75 AMP
- 🔄 **Radial Drill** 45" h x 40" carrera"
- 🔄 **Flat Grinding**
- 🔄 **Welding** TIG, MIG, STICK, Spool Gun,



Smart Specialists

All our projects and prototypes are designed using the **most innovative** in computer applications, through the combination of CAD, CAM, CAE, CNC systems and skilled labor team.



Smart Competitive Advantages

SDM support the industry with:

3 key advantages:

- 🔄 Excellent **command** in the manufacture parts.
- 🔄 Innovative services with **new technology** through our **development center**.
- 🔄 **Commitment to excellence** in the delivery service: anytime and anywhere.



Why **SDM**?



- 🔄 We have the **experience**, the **trained personnel** and the best **tools** to guarantee a profesional and highly **competitive service**.
- 🔄 We are at your service to know your needs, and support you with **integrated and immediate solutions**

Smart Alliances (Main suppliers)

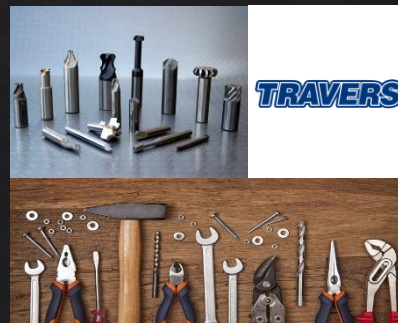
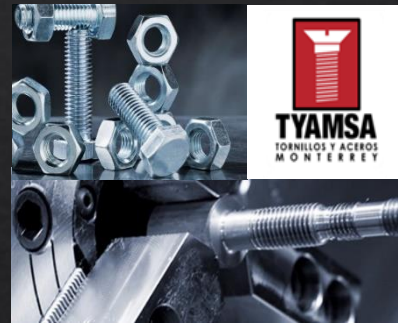

Smart Facts

Delivered
products

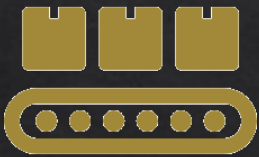

10,181*

Completed projects

New
developments

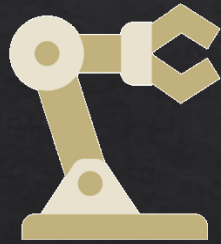

399

Designs created

Improvement
projects

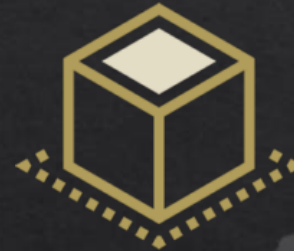

144

interventions

Delivery
Time*



Mechanized: **1-2** Weeks

Projects: **1-3** months

*To first semester of 2020

*Delivery Time: In Nuevo León, México. Delivery time may vary according to city, state or country.

Smart Contact & Social Media

Find us as **Smart Design for Manufacturing**



www.sdfm.com.mx



Sales and Project quotation:
info@sdfm.com.mx



[@beSMART.beSDM](https://www.facebook.com/beSMART.beSDM)



811-905-9926
Monterrey, NL. México.



[Smart Design for
Manufacturing](https://www.linkedin.com/company/smart-design-for-manufacturing)



52 811-905-9926 – [WhatsApp Me](https://www.whatsapp.com/channel/0029-l8119059926)
52 8119659685 – [WhatsApp Me](https://www.whatsapp.com/channel/0029-l8119659685)



SDM

Smart Design for Manufacturing

Be Smart. Think Smart.

www.sdfm.com.mx



ASOCIADO
AMMT



**SDM Smart Design for
Manufacturing**



info@sdfm.com.mx
aldoduenas@sdfm.com.mx
andreamarin@sdfm.com.mx



+521 811 905 9926
+521 811 965 9685



www.sdfm.com.mx